

IN-STOCK

# Mailbox Locks

FOR INTERIOR ARCHITECTURAL MAILBOXES



### MBL82010 Features:

- Used in apartments, condominiums, schools, lobbies
- Nut or clip mounted
- 90° counter-clock-wise cam turn to open.
- Key removable in locked position only.
- Supplied with selection of five cams, two keys, mounting nut, mounting clip, lock washer and cam screw.

Stock ID 82010 • 25 to box

## Other FJM Cabinet Products

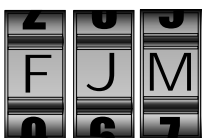

Innovative, Quality Security Solutions

[www.fjmsecurity.com](http://www.fjmsecurity.com)

18424 HWY 99, Lynnwood WA 98037

800-654-1786

Security Products

# Mailbox Locks

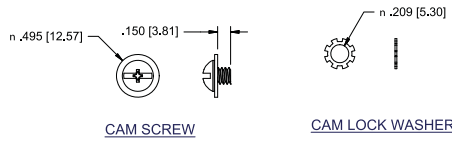
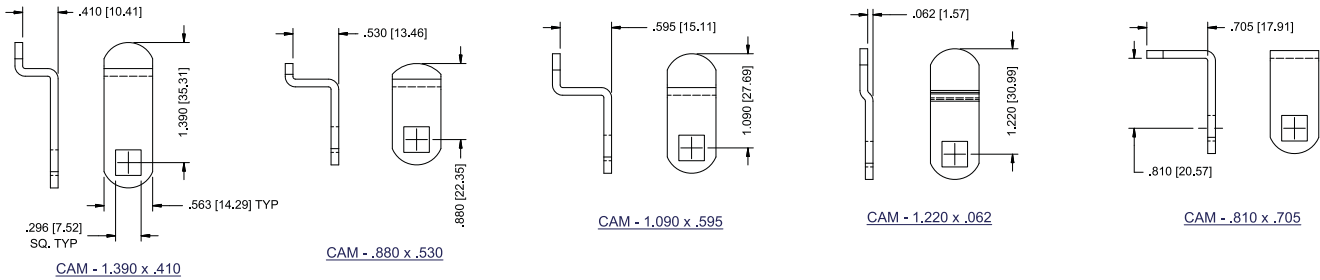
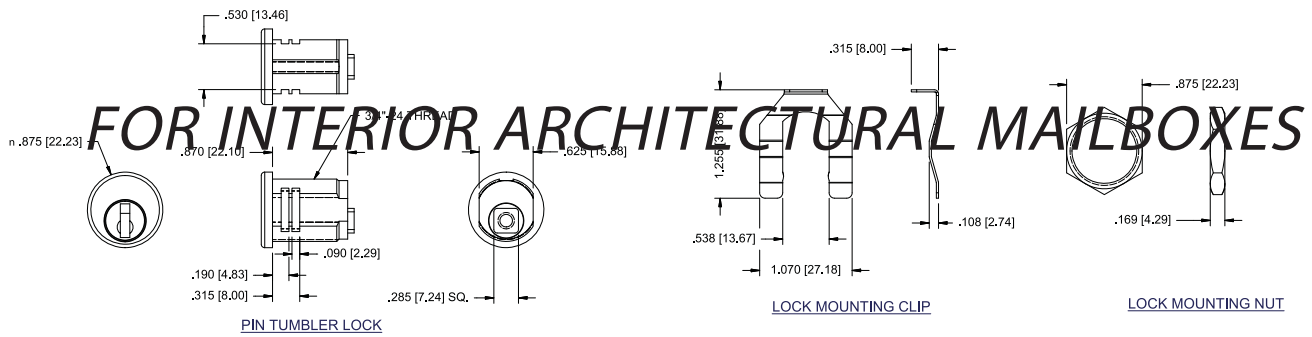

- NOTES:
1. LOCK, KEYS, AND ALL HARDWARE PACKED TOGETHER IN PRINTED AND SEALED POLY BAG (SEE ARTWORK FOR BAG PRINTING).
  2. LOCK KIT SUPPLIED WITH 2 KEYS. CCL LOGO STAMPED ON HEAD.
  3. LOCKS KEYED DIFFERENT TO xxx COMBINATIONS.

## MBL82010 MAILBOX LOCK

### Contents:

Lock cylinder with two keys, multi-cam assortment, mounting clip and nut, cam screw with lockwasher.

### Description:

Diecast cylinder with nickel plated face; brass pins; spring steel locking clip; replaces many manufacturers' original equipment product; these multi-cam assortments can eliminate stocking of individual locks; all cylinders rotate 90° counter clockwise to open.

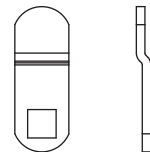

Bommer

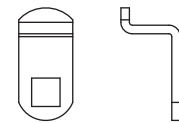

Florence

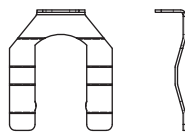

Mounting Clip



Auth Ele



American

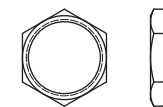

Mounting Nut

### MBL82010 Features:

- Used in apartments, condominiums, schools, lobbies
- Nut or clip mounted
- 90° counter-clock-wise cam turn to open.
- Key removable in locked position only.
- Supplied with selection of five cams, two keys, mounting nut, mounting clip, lock washer and cam screw.

Stock ID 82010 • 25 to box



Lock Washer



Innovative, Quality Security Solutions

www.fjmsecurity.com

18424 HWY 99, Lynnwood WA 98037

800-654-1786